

MICE

in FUKUI, JAPAN FACILITY GUIDE



In 2024 scheduled to open
Spring

Fukui City Central Bldg !

Hotel : 252 rooms
Banquet hall : capacity for
1000 people (planned)

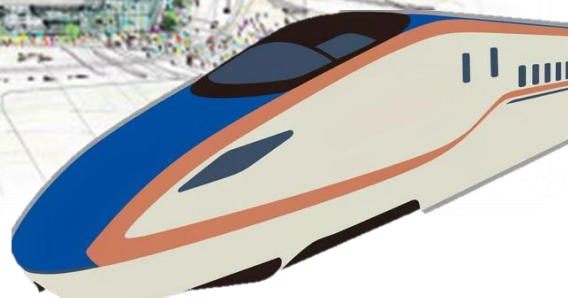

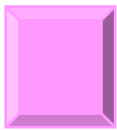

T T



- ★parking (fee required)
(403cars)
- ★Wi-Fi · Wired LAN available
- ★Restaurant
(Catering service available)

		(m)	° () ()	(m)		()	()	()		
Main hall	1	1,200	34 × 36	8	—	800	2,000	700	1,000	Exclude Stage. Party allowed unless motorized moving seats are used.
Small hall	2	304	16 × 19	4.5	—	200	500	180	250	Party allowed unless motorized moving seats are used.
Underground hall	B1	300	13 × 20	2.8	—	195	195	100	150	Party allowed Possible in two parts with partitions.
Multi purpose hall	3	210	10 × 18	6.1	—	108	108	—	—	
Video hall	3	175	10 × 14	2.6	118	—	—	—	—	No food and drink allowed

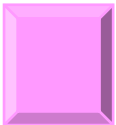

B



- ★Parking (fee required)
(400cars)
- ★Wi-Fi · Wired LAN available
(free of charge)
- ★Restaurant and Cafe
(Japanese / Western /
Chinese)

		(m)	° () ()	(m)		()	()	()		
Tenzan (whole)	3	656	31.5 × 20	4.8	—	378	600	370	500	3div. available
Tenzan (2/3)	3	430	20 × 20	4.8	—	240	380	220	250	
Tenzan (1/3)	3	205	10 × 20	4.8	—	117	168	100	110	
Zui-un	3	200	13.9 × 14.2	2.6	—	141	162	90	100	
Aoi	3	185	10.8 × 17	2.9	—	108	150	80	90	
Sakae	4	105	13.3 × 7.9	2.7	—	48	84	48	50	
Akane	4	105	11.7 × 5.9	2.7	—	36	60	32	40	

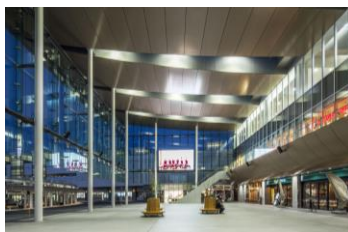
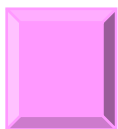

- ★Parking (fee required)
(475cars)
- ★Wi-Fi partly available
- ★Restaurant
(in Happiring moll)

		(㎡)	° () ()	(m)		()	()	()		
① Happiring hall	3	420	19.3 × 21.5	8	—	198	240	120	—	Exclude stage. Party allowed unless motorized moving seats are used.
① Rehearsal room	4	98	14.9 × 6.6	—	—	—	—	—	—	Glazed on one side.
① Happiterrace	1	630	—	—	—	—	—	—	—	Open space for all weather conditions.
② Seiren Planet Dome Theater	5	360	—	9	150	—	150	—	—	Wi-Fi is not available
② Seiren Planet Multi-purpose room	5	105	—	3.2	—	30	96	—	100	Wi-Fi is not available

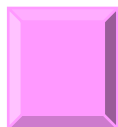

B

B

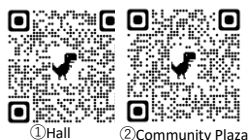

- ★Parking (fee required)
(169cars)
- ★Wi-Fi available
- ★Restaurant
(in AOSSA)

		(㎡)	° () ()	(m)		()	()	()		
① Fukui Prefectural hall	8	381	25 × 15	10	240	210	535	240	273	Stage 398.37㎡ (Depths12.9m 、 lengths13.4m 、 Height7.2m) 、 weight limit500kg/㎡ Party is partly available
① Rehearsal room	8	138	14 × 9.9	4	—	72	100	—	60	Exhibition or poster session is available. Party is partly available.
② Seminar room 601ABC	6	270	9.7 × 26.2	3	—	162	—	—	—	3div .available
② Seminar601A	6	90	9.7 × 8.5	3	—	54	—	—	—	
② Seminar601B	6	90	9.7 × 8.9	3	—	54	—	—	—	
② Seminar601C	6	90	9.7 × 8.5	3	—	54	—	—	—	
② Seminar607	6	360	8.4 × 13.7	3	—	81	—	—	—	
② Recreation room	6	105	18 × 15.5	3	—	180	—	—	—	2 div. available

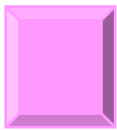

B
K



For reservation



>

B B



- ★Parking (free of charge)
(500cars)
- ★Wi-Fi available

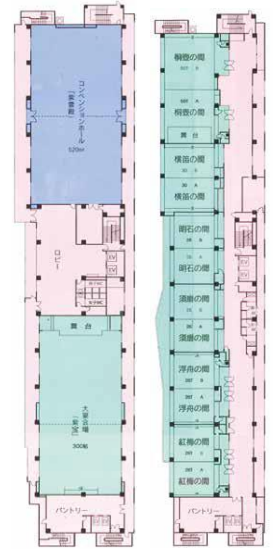

		(㎡)	o () ()	(m)		()	()	()		
Convention hall	7	525	16.3 × 32.2	6	—	450	700	240	450	Food and drink available.
Shiho	7	385	14 × 28	3.3	—	230	340	—	—	Food and drink available. 2div.available
Daikan	6	455	13.6 × 33.5	3.1	—	270	380	—	—	Food and drink available. 3div.available
Zuiho	6	157	10 × 15.7	2.7	—	56	—	—	—	Food and drink available. 2 div .available
Akashi・Suma	3	90	7.2 × 12.5	2.6	—	78	110	—	—	Food and drink available. 2 div .available
Kiritsubo	3	154	9 × 17.1	2.6	—	56	—	—	—	Food and drink available. 2 div .available
Yokobue	3	98	9 × 10.8	2.6	—	40	—	—	—	Food and drink available. 2div. Available
Kobai/ Ukifune	3	83	7.2 × 11.5	2.6	—	30	—	—	—	Food and drink available. 2div. available

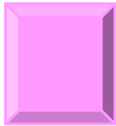

B
B IB



- ★Parking (free of charge)
(300cars)
- ★Wi-Fi available
- ★Restaurant



		(㎡)	o () ()	(m)		()	()	()		
Grandia hall	5	341	25.8 × 18	11.2	—	300	600	300	500	Dedicated escalator Reception desk 250 inch screen Audio equipment 300 persons available for Banquet
Jurakuden	2	174	12 × 15	3	—	120	250	—	—	120 persons available for Banquet
Dairin	3	578	17 × 34	4.3	—	—	—	—	—	500 persons available for Banquet
A-un	4	213	7.9 × 27	3	—	120	120	—	—	100 persons available for Banquet